



# euroscreen® Diplomat Tab Tension

## SCREEN SURFACES



### FlexWhite

Pliable matt white front surface, superb colour rendition, Full HD compliant. Gain 1.0.



### ReAct 2.1

Pliable silver grey front surface, enhances colour contrast in bright light, Full HD compliant. Gain 1.0.



### FlexRear

White material with microscopic perforations which create a sound transparent projection surface. Gain 0.8.



### FlexRear

Neutral grey rear projection surface. Only available without borders. Gain 2.5.

## PROJECTION FORMATS



The screen format is 4:3. No black borders.

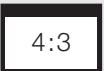

The screen has 5 cm wide black borders. The format of the viewing area is 4:3.



The screen has 5 cm wide black borders. The format of the viewing area is 16:10.

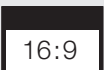

The screen has 5 cm wide black borders. The format of the viewing area is 16:9.

## CONTROL OPTIONS



### Installation

5m cable. Needs to be installed by electrician.



### Switch

The screen is operated by a 3-positions in-line switch.

Diplomat is a high quality screen which, thanks to the robust construction and flexible installation, is the preferred screen among our professional buyers. The installation is very flexible with mounting brackets that can be adjusted sideways to preferred positions. The screen can be mounted on the wall as well as in the ceiling. It comes in a white aluminium case and can be operated by an in-line switch, an IR or RF remote control or automatically by an AutoLink connected to the projector. For system installations it's also available with cable only. All control options are easily connected to the screen via the universal connector on the back of the case. The Diplomat Tab Tension has a tensioning system along the sides which gives the flattest possible viewing surface.

**CAUTION:** Do not install close to a heat source; e.g. in front of a TV set, direct sunlight, radiators etc.

## SCREEN DIMENSIONS



## CASE DIMENSIONS

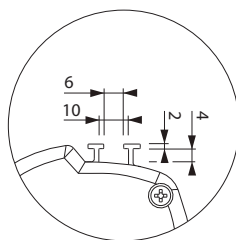
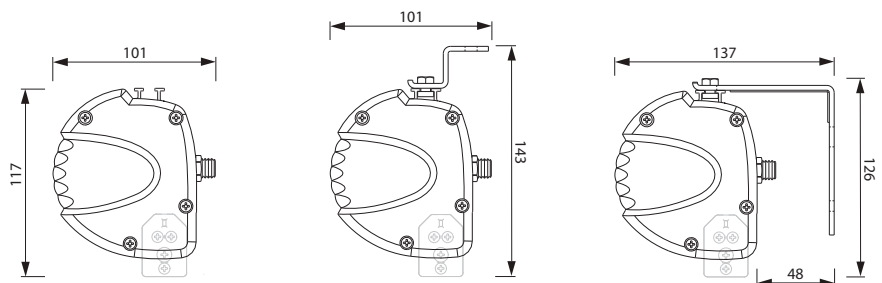

## ELECTRICAL SPECIFICATIONS

### Cable Specifications

Thickness:  $\varnothing$  7 mm  
 Cable area: 4x0,5mm<sup>2</sup> , motor to control  
 3x0,75mm<sup>2</sup> , control to plug  
 Wires: Black - Up  
 Brown - Down  
 Blue - Neutral  
 Green/Yellow - Ground

### Plug options

Motorized screens, except Installation version, are delivered with either Euro plug or UK plug (both grounded).

### Motor Specifications

Voltage: 230 V      Frequency: 50 Hz  
 Power: 121 W      Momentum: 6Nm  
 Speed: 28 rpm      Protection: IP44

The motor is grounded.

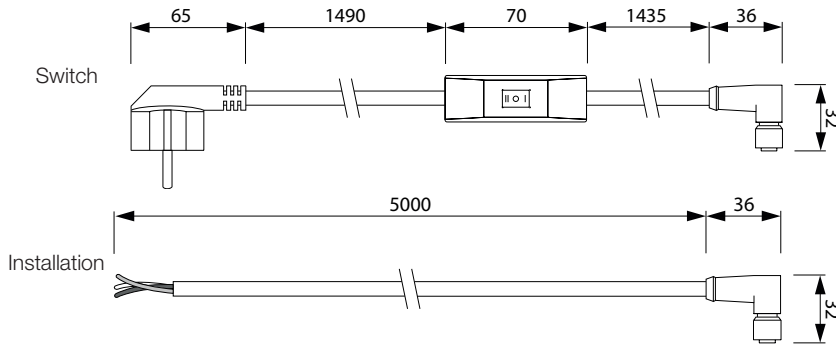

## BRACKET DIMENSIONS

### Brackets – Wall

Included in all Diplomat products

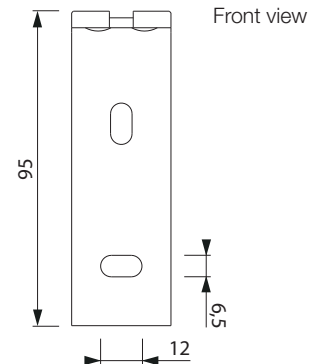
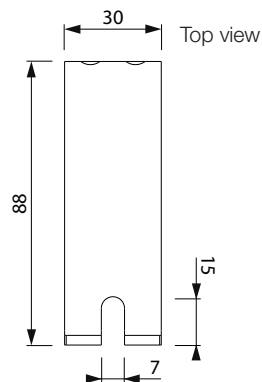

### Brackets – Ceiling

Included in all Diplomat products

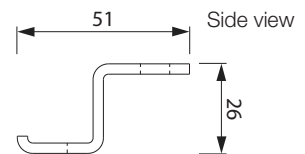
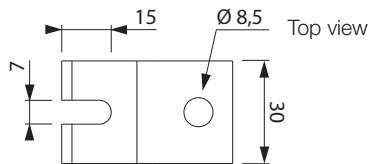

## PACKAGING DIMENSIONS

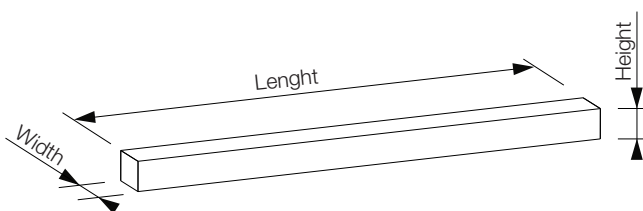

Screen width	Box length	Box width	Box height
1600	2080	165	170
1800	2280	165	170
2000	2480	165	170
2200	2680	165	170
2400	2880	165	170