



Installation Guide

celexon screen electric professional plus

Please read the installation instructions carefully before using the screen.

Please keep for future reference



celexonTM
www.celexon.com



Electrical spec

Voltage: 100V ~ 120V, 60Hz
or 200V ~ 240V, 50Hz

Power consumption: 130W (max), 0.4W (standby)

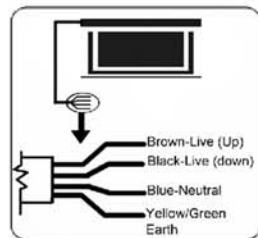

Installation

Install the screen so that it is central for most viewers. When fully extended, please ensure that the lower third is about eye level. The screen can be wall or ceiling mounted by screws or it can be fixed via hanging hooks from the ceiling.
(you may be required to purchase screws/hooks suitable for your specific building material – for mounting on a brick/concrete surface, use Ø 6x50mm screws/wall plugs, for mounting on a wooden surface, use Ø 4x50mm wood screws).

Ceiling installation (via hanging hooks)

Attach the hooks to both end caps and measure the distance between the hooks. Mark out positions on the ceiling and ensure that hooks are aligned and parallel to wall. Drill holes where marked and hook up the screen. (you may need to purchase wall plugs/screws suitable for your ceiling material).

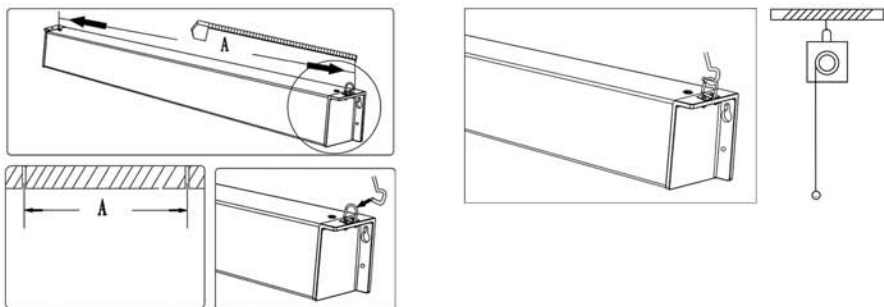

Ceiling installation (screwed)

Measure the distance of the holes on the end caps (2 on each side) and mark on the ceiling. Ensure that the holes are parallel to the wall. Use wall plugs and screws suitable for your ceiling material and screw the screen to the ceiling.

PLEASE NOTE: do not over tighten the screws! If you see cracks in the end caps, they must be replaced. Do not use the screen.

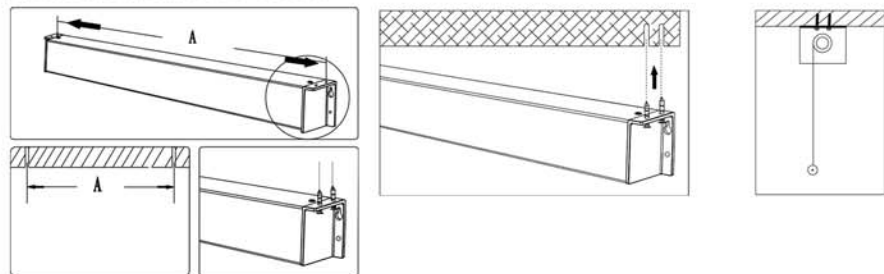

Installation

Wall installation (unscrew hooks beforehand if desired)

Measure the distance of the holes on the end caps and mark on the wall. Ensure that they are absolutely level. Use wall plugs and screws suitable for your wall. Screw the two top screws into the wall up to 1cm and hang the screen on each side in the upper hole.

PLEASE NOTE: do not over tighten the screws! If you see cracks in the end caps, they must be replaced. Do not use the screen if caps have cracked.

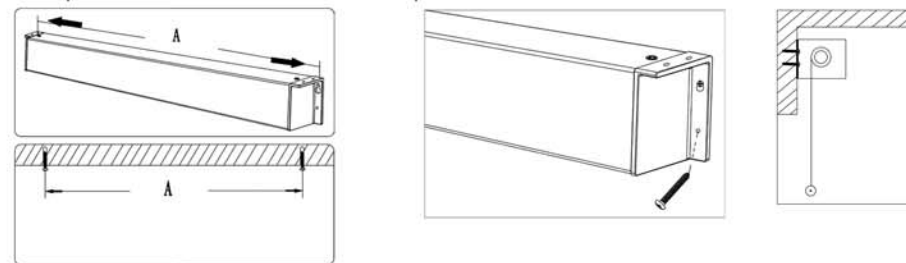

Operating instructions

Operating the screen via wall switch

Plug power cable into socket (ensure correct voltage). Position the cable so that it does not present a hazard or comes into contact with any hot surface. You may require an extension lead.

To lower the screen (see fig 2)

When you set the switch to \leq , the screen will come down and stop automatically at its stop position.

To retract the screen (see fig 3)

When you set the switch to \geq , the screen will automatically retract into its housing and default stop at the upper stop position

To stop the screen

When you set the switch to $< 0 >$, the screen will stop immediately

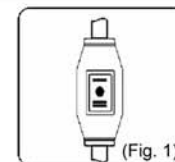

(Fig. 1)

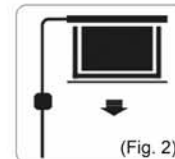

(Fig. 2)

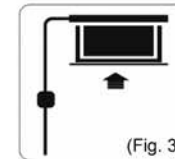

(Fig. 3)

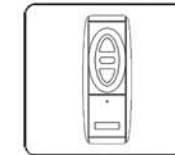

(Fig. 4)

Wireless operation (infra red) (see fig 4)

To lower the screen

If you press the lower button on the remote control, the screen will automatically lower itself and stop at the default stop position.

To retract the screen

If you press the top button on the remote control, the screen will automatically retract into its housing and stop when fully retracted.

To stop the screen manually

If you wish to stop the screen, press the middle button on your remote control at any point.

To adjust the stop positions (Please note that any damage caused by incorrect tampering of the stop positions will not be covered under the warranty)



Lower limit: — Adjusting the lower stop limit is only possible when the screen is fully extended. To extend the lower limit, turn the 'lower limit' Allen key hole clockwise in small increments

Upper limit: — Adjusting the upper stop limit is only possible when the screen is fully retracted into the housing. To adjust the upper limit, turn the 'upper limit' Allen key hole clockwise, again in small increments.

PLEASE NOTE: Excessive adjustments may cause irreversible damage to the screen motor and will not be covered under the warranty.